

RESOLUTION

DEDICATION OF STREETS IN GOVERNOR'S LAND AT

TWO RIVERS, TRAVIS POND AND WHITTAKER ISLAND, BLOCKS A AND B

WHEREAS, the streets described on the attached Additions Form SR-5(A)s, fully incorporated herein by reference, are shown on plats recorded in the Clerk's Office of the Circuit Court of James City County; and

WHEREAS, the Resident Engineer for the Virginia Department of Transportation has advised this Board the streets meet the requirements established by the Subdivision Street Requirements of the Virginia Department of Transportation; and

WHEREAS, the County and the Virginia Department of Transportation have entered into an agreement on November 1, 1993, for comprehensive stormwater detention which applies to this request for addition.

NOW, THEREFORE, BE IT RESOLVED that the Board of Supervisors of James City County, Virginia, hereby requests the Virginia Department of Transportation to add the streets described on the attached Additions Form SR-5(A) to the secondary system of State highways, pursuant to §33.1-229, Code of Virginia, and the Department's Subdivision Street Requirements.

BE IT FURTHER RESOLVED, this Board guarantees a clear and unrestricted right-of-way, as described, and any necessary easements for cuts, fills and drainage.

BE IT FURTHER RESOLVED that a certified copy of this resolution be forwarded to the Resident Engineer for the Virginia Department of Transportation.

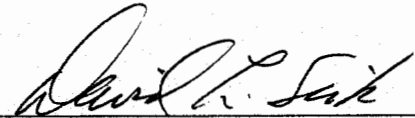

David L. Sisk  
Chairman, Board of Supervisors

ATTEST:

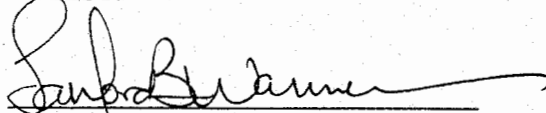

Sanford B. Wanner  
Clerk to the Board

<u>SUPERVISOR</u>	<u>VOTE</u>
TAYLOR	AYE
MAGOON	AYE
DEPUE	AYE
EDWARDS	AYE
SISK	AYE

Adopted by the Board of Supervisors of James City County, Virginia, this 10th day of September, 1996.

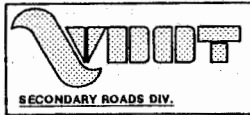

**ADDITIONS FORM SR-5(A) - Proposed Additions to the Secondary System of State Highways**

Attachment to  one  Board of Supervisors Resolution  Surety Dated: 9/10/96

Attachment 1 of 2

Name of Subdivision: Governor's Land, Travis Pond

James City County

Ref. No.	Name of Street (Required Data Field)	Street Addition Termini	R-O-W Width (ft)	Miscellaneous Notes	Centerline Length (mil)
1	Two Rivers Road	From: Route 5 To: 0.27 mi. south of Route 5 Plat Recorded Date: 02/20/91 Plat Book: 53 Page 81-89	120	# Occupied Dwl. 0 Other Service: Collector Road Description: Bit. conc. surface, curb & gutter, median	0.27
2	Two Rivers Road	From: 0.27 mi. south of Route 5 To: 0.45 mi. west of Two Rivers Road Plat Recorded Date: 02/20/91 Plat Book: 53 Page 81-89	80	# Occupied Dwl. 0 Other Service: Collector Road Description: Bit. conc. surface, open roadside ditches	0.45
3	Travis Pond Road	From: Two Rivers Road To: West Island Road Plat Recorded Date: 02/20/91 Plat Book: 53 Page 81-89	120	# Occupied Dwl. 10 Other Service: Description: Bit. conc. surface, curb & gutter	0.24
4	Travis Close	From: Travis Pond Road To: 0.11 mi. east of Travis Pond Road Plat Recorded Date: 02/20/91 Plat Book: 53 Page 81-89	50	# Occupied Dwl. 5 Other Service: Description: Bit. conc. surface, curb & gutter	0.11
5	West Island Road	From: Travis Pond Road To: 0.19 mi. west of Travis Pond Road Plat Recorded Date: 02/20/91 Plat Book: 53 Page 81-89	50	# Occupied Dwl. 8 Other Service: Description: Bit. conc. surface, curb & gutter	0.19
6	West Island Road	From: Travis Pond Road To: 0.19 mi. east of Travis Pond Road Plat Recorded Date: 02/20/91 Plat Book: 53 Page 81-89	50	# Occupied Dwl. Other Service: Description:	0.19
7		From: To: Plat Recorded Date: Plat Book: Page		# Occupied Dwl. Other Service: Description:	
Total Mileage					<u>1.45</u>

Notes: Guaranteed width of right of way exclusive of any necessary easements for cuts, fills, and drainage.

Magisterial District Powhatan

<p>CERTIFICATION OF ATTACHMENT (by county clerk or surety agent)</p> <p>This attachment is certified a part of the document <input checked="" type="checkbox"/> above.</p> <p><u>Sally Burman</u> CLERK TO BOARD</p> <p>(Name and Title)</p>	
--	--

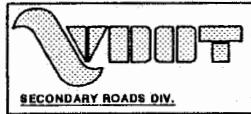

**ADDITIONS FORM SR-5(A) - Proposed Additions to the Secondary System of State Highways**

Attachment to  one  Board of Supervisors Resolution  Surety Dated: 9/10/96

Attachment 2 of 2

Name of Subdivision: Governor's Land, Whittaker's Island, Blocks A & B

James City County

Ref. No.	Name of Street (Required Data Field)	Street Addition Termini	R-O-W Width (ft)	Miscellaneous Notes	Centerline Length (mil)
1	Whittaker Island Road	From: Two Rivers Road To: Sanctuary Drive Plat Recorded Date: 02/20/91 Plat Book: 53 Page 90-96	90.56-50	# Occupied Dwl. 20 Other Service: Description: Bit. conc. surface, curb and gutter	0.36
2	West Whittaker Close	From: Whittaker Island Road To: Whittaker Island Road via loop Plat Recorded Date: 02/20/91 Plat Book: 53 Page 90-92	50	# Occupied Dwl. 7 Other Service: Description:	0.23
3	South Freeman Road	From: Two Rivers Road To: Whittaker Island Road Plat Recorded Date: 02/20/91 Plat Book: 53 Page 90-92	50	# Occupied Dwl. 10 Other Service: Description: Bit. conc. surface, curb and gutter	0.22
4	East Whittaker Close	From: Whittaker Island Road To: End of permanent cul-de-sac Plat Recorded Date: 02/20/91 Plat Book: 53 Page 90-92	50	# Occupied Dwl. 4 Other Service: Description: Bit. conc. surface, curb and gutter	0.09
5	East Island Road	From: Whittaker Island Road To: End of permanent cul-de-sac Plat Recorded Date: 02/20/91 Plat Book: 53 Page 90-92	50	# Occupied Dwl. 10 Other Service: Description: Bit. conc. surface, curb and gutter	0.20
6	Sanctuary Drive	From: East Island Road To: End of permanent cul-de-sac Plat Recorded Date: 02/20/91 Plat Book: 53 Page 93-96	50	# Occupied Dwl. 8 Other Service: Description: Bit. conc. surface, curb and gutter	0.28
7		From: To: Plat Recorded Date: Plat Book: Page		# Occupied Dwl. Other Service: Description:	
Notes: Guaranteed width of right of way exclusive of any necessary easements for cuts, fills, and drainage.					Total Mileage <u>1.38</u>

Magisterial District Powhatan

<p>CERTIFICATION OF ATTACHMENT (by county clerk or surety agent)</p> <p>This attachment is certified a part of the document <input checked="" type="checkbox"/> above.</p> <p><i>[Signature]</i>                  Clerk to the Board</p> <p>(Name and Title)</p>
--

# DEDICATION OF STREETS IN GOVERNOR'S LAND

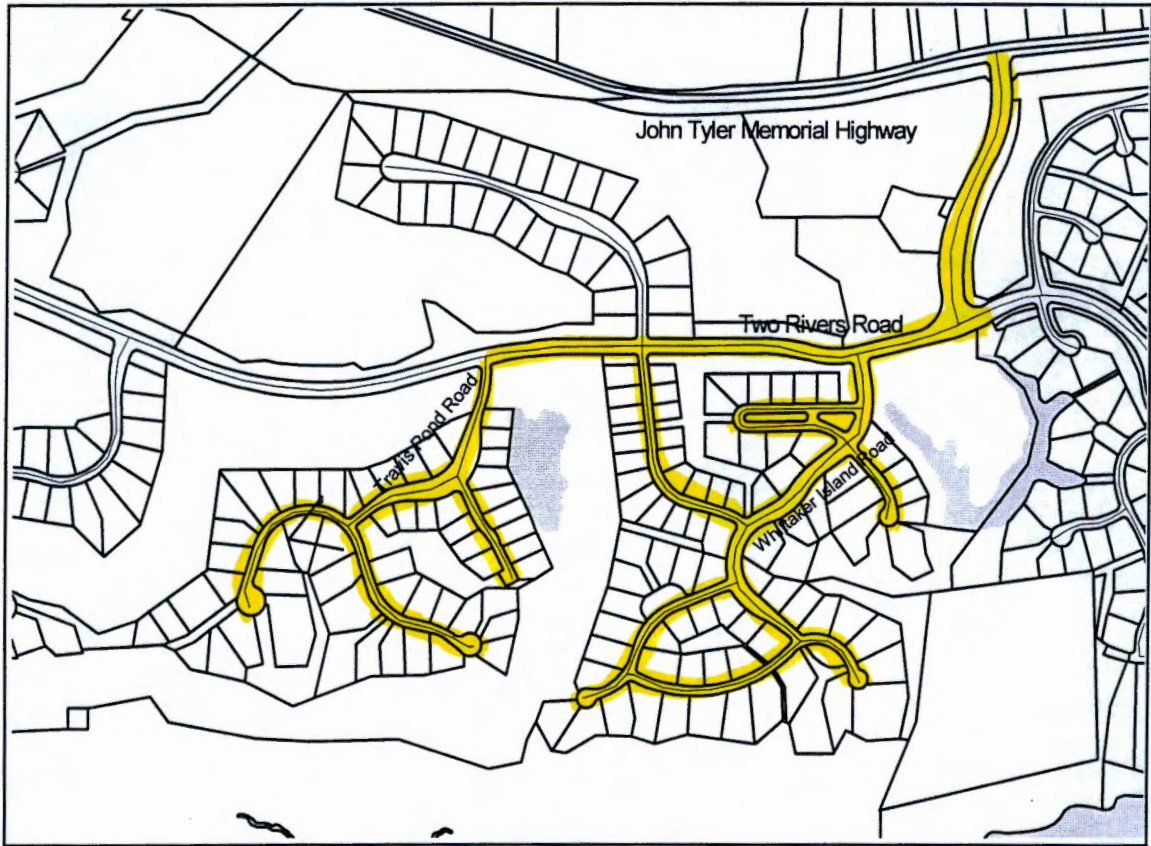

- Parcels
- Roads
- Streets Being Dedicated
- Streams

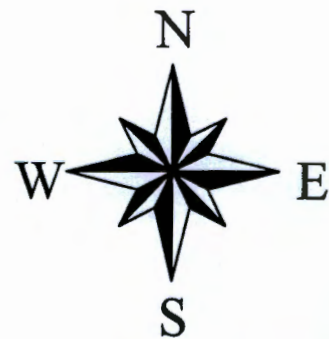

3000 0 3000 Feet

