

**RESOLUTION**

CASE NO. SUP-3-04. LAFAYETTE HIGH SCHOOL

CASE NO. SUP-4-04. JAMESTOWN HIGH SCHOOL

**TEMPORARY CLASSROOM TRAILERS**

WHEREAS, all conditions for the consideration of these special use permit applications have been met; and

WHEREAS, temporary classroom trailers accessory to an existing school may be permitted upon the issuance of a special use permit by the Board of Supervisors; and

WHEREAS, the Williamsburg-James City County School Board has applied for a special use permit to allow one new temporary classroom trailer and extend the expiration date of two existing temporary classroom trailers at Lafayette High School on property owned and developed by the applicant located at 4460 Longhill Road, and further identified as Parcel No. (1-1) on James City County Real Estate Tax Map No. (32-3); and

WHEREAS, the Williamsburg-James City County School Board has applied for a special use permit to allow one new temporary classroom trailer and extend the expiration date of one temporary classroom trailer at Jamestown High School on property owned and developed by the applicant located at 3751 John Tyler Highway, and further identified as Parcel No. (1-2D) on James City County Real Estate Tax Map No. (46-1).

NOW, THEREFORE, BE IT RESOLVED that the Board of Supervisors of James City County, Virginia, hereby approves the issuance of special use permits for the placement of temporary classroom trailers as described above and on the attached site location maps with the following condition:

1. These permits shall be valid until July 1, 2007.



Bruce C. Goodson  
Chairman, Board of Supervisors

ATTEST:

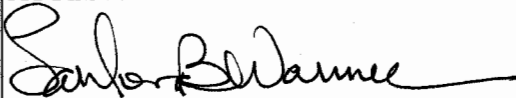

Sanford B. Wanner  
Clerk to the Board

<u>SUPERVISOR</u>	<u>VOTE</u>
BRADSHAW	AYE
HARRISON	AYE
BROWN	AYE
MCGLENNON	AYE
GOODSON	AYE

Adopted by the Board of Supervisors of James City County, Virginia, this 13th day of April, 2004.

LAFAYETTE HIGH SCHOOL  
4460 LONGHILL ROAD  
TAX MAP (32-3) (1-1)

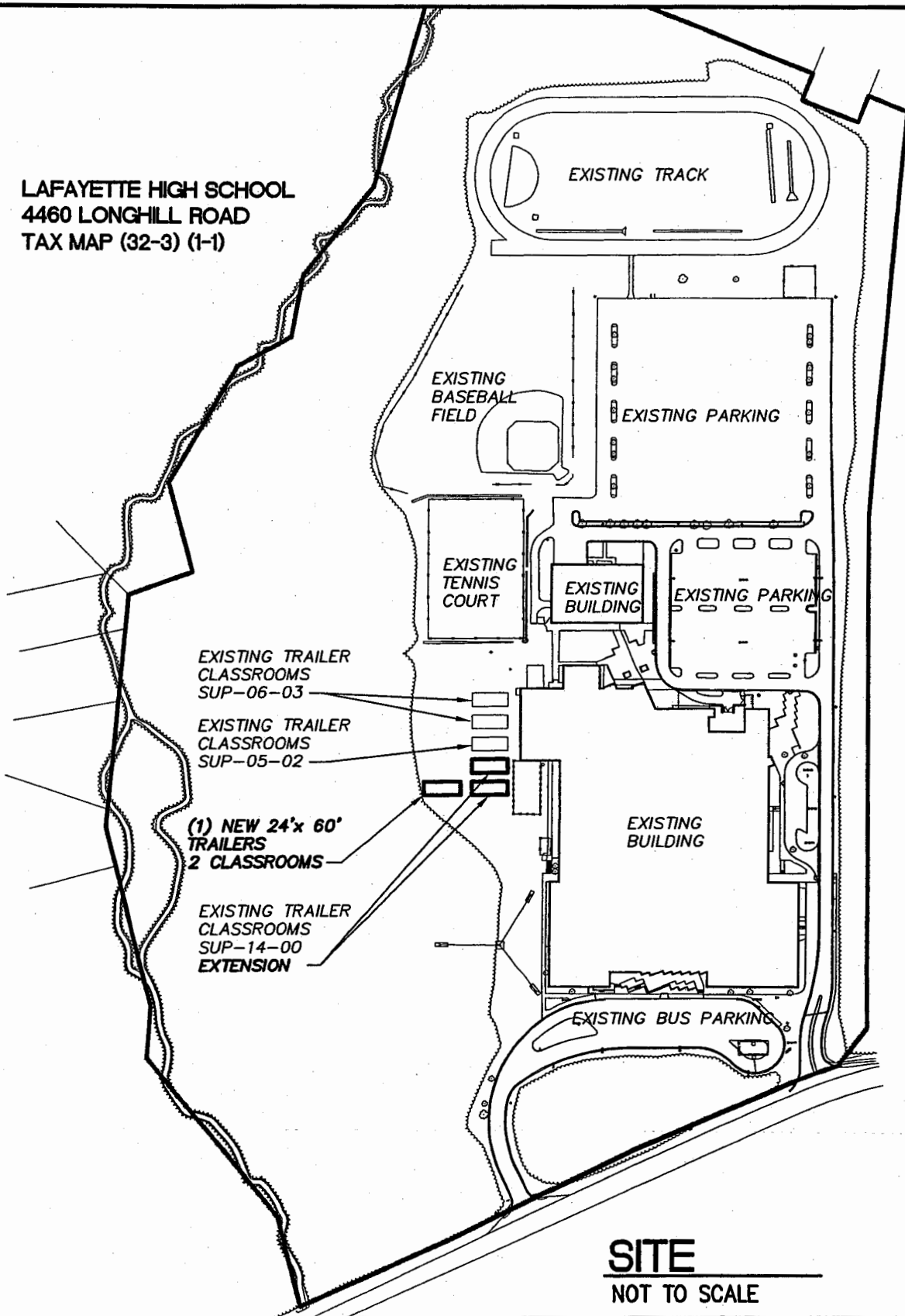

**SITE**  
NOT TO SCALE



Consulting Engineers

Engineers, Surveyors, Planners

Williamsburg, Virginia

TRAILER CLASSROOM  
**LAFAYETTE HIGH SCHOOL**  
WILLIAMSBURG/JAMES CITY COUNTY SCHOOLS

POWHATAN DISTRICT

JAMES CITY COUNTY VIRGINIA

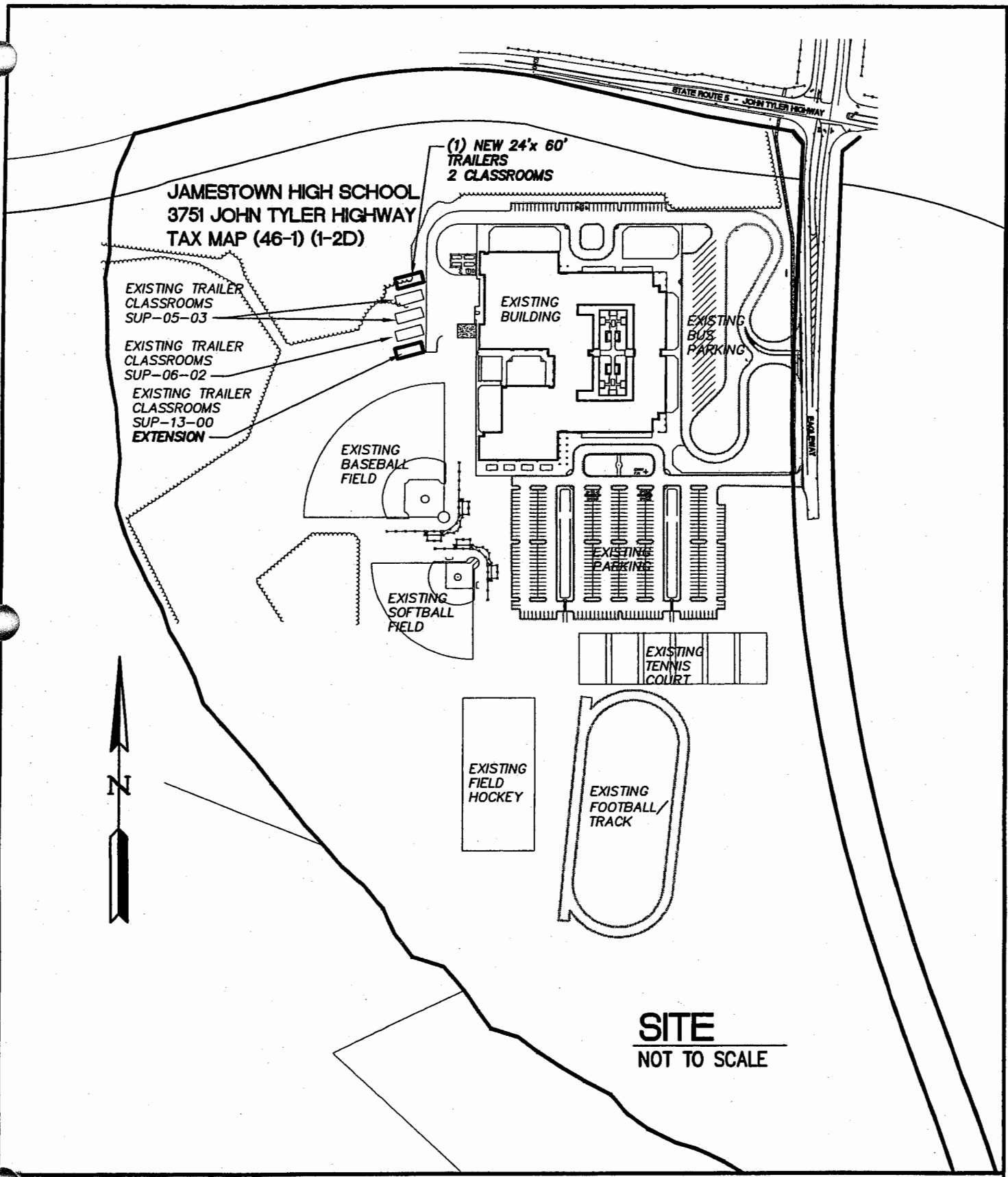

**JAMESTOWN HIGH SCHOOL**  
**3751 JOHN TYLER HIGHWAY**  
**TAX MAP (46-1) (1-2D)**

EXISTING TRAILER  
 CLASSROOMS  
 SUP-05-03

EXISTING TRAILER  
 CLASSROOMS  
 SUP-06-02

EXISTING TRAILER  
 CLASSROOMS  
 SUP-13-00  
 EXTENSION

(1) NEW 24'x 60'  
 TRAILERS  
 2 CLASSROOMS

EXISTING  
 BUILDING

EXISTING  
 BUS  
 PARKING

EXISTING  
 BASEBALL  
 FIELD

EXISTING  
 SOFTBALL  
 FIELD

EXISTING  
 PARKING

EXISTING  
 TENNIS  
 COURT

EXISTING  
 FIELD  
 HOCKEY

EXISTING  
 FOOTBALL/  
 TRACK

**SITE**  
 NOT TO SCALE



**Consulting Engineers**

**Engineers, Surveyors, Planners**

**Williamsburg, Virginia**

TRAILER CLASSROOM  
**JAMESTOWN HIGH SCHOOL**  
**WILLIAMSBURG/JAMES CITY COUNTY SCHOOLS**

BERKELEY DISTRICT

JAMES CITY COUNTY VIRGINIA