

**JAMES CITY COUNTY WETLANDS AND CHESAPEAKE BAY BOARD
WORK SESSION
MINUTES
DECEMBER 11, 2007 – 1:00 PM**

A. ROLL CALL

John Hughes
Larry Waltrip
David Gussman
William Apperson

ABSENT

Henry Lindsey

OTHERS PRESENT

County Staff
Kevin Kolda, Busch Properties
Chris Frye, Vanasse Hangen Brustlin, Inc. (VHB)
Jim Gunn, Coastal Design & Construction (CD&C)
Pamela Mason, Virginia Institute of Marine Science (VIMS)
Dr. Gerald H. Johnson, Professor Emeritus, William & Mary, Department of Geology

B. OPEN MEETING

Mr. Apperson opened the informational meeting for Wetlands Board Case W-25-07 and Chesapeake Bay Board case CBE-07-107 pertaining to Busch Properties Inc., Kingsmill-Spencer's Grant.

C. PRESENTATION

County staff provided copies of the proposed project and site (copy attached).

Chris Frye, VHB, representing the applicant, Busch Properties gave a presentation briefly describing the proposed shore line project and Resource Protection Area (RPA) impacts.

Gerald Johnson spoke on the historic significance of the area due to the fossil formations on the bluffs.

Pam Mason stated the findings from VIMS (copy attached) were based on a balance of shoreline protection and socioeconomic development.

The meeting recessed at 1:20

D. FIELD TRIP

The meeting reconvened at 1:40 at the Kingsmill, Spencer's Grant project site.

Representatives from Bush Properties, VHB, and CD&C conducted a tour of the site, showing the areas of the RPA that would be graded, the location of the proposed revetment and breakwaters as well as areas that would be preserved.

Gerald Johnson spoke about the history of the area and pointed out the exposed fossil formations.

E. ADJOURNMENT

The meeting adjourned at 2:45 PM.



John Hughes
Chairman, Wetlands Board



William Apperson
Chairman, Chesapeake Bay Board



Patrick T. Menichino
Secretary, Wetlands Board



Scott J. Thomas
Secretary, Chesapeake Bay Board

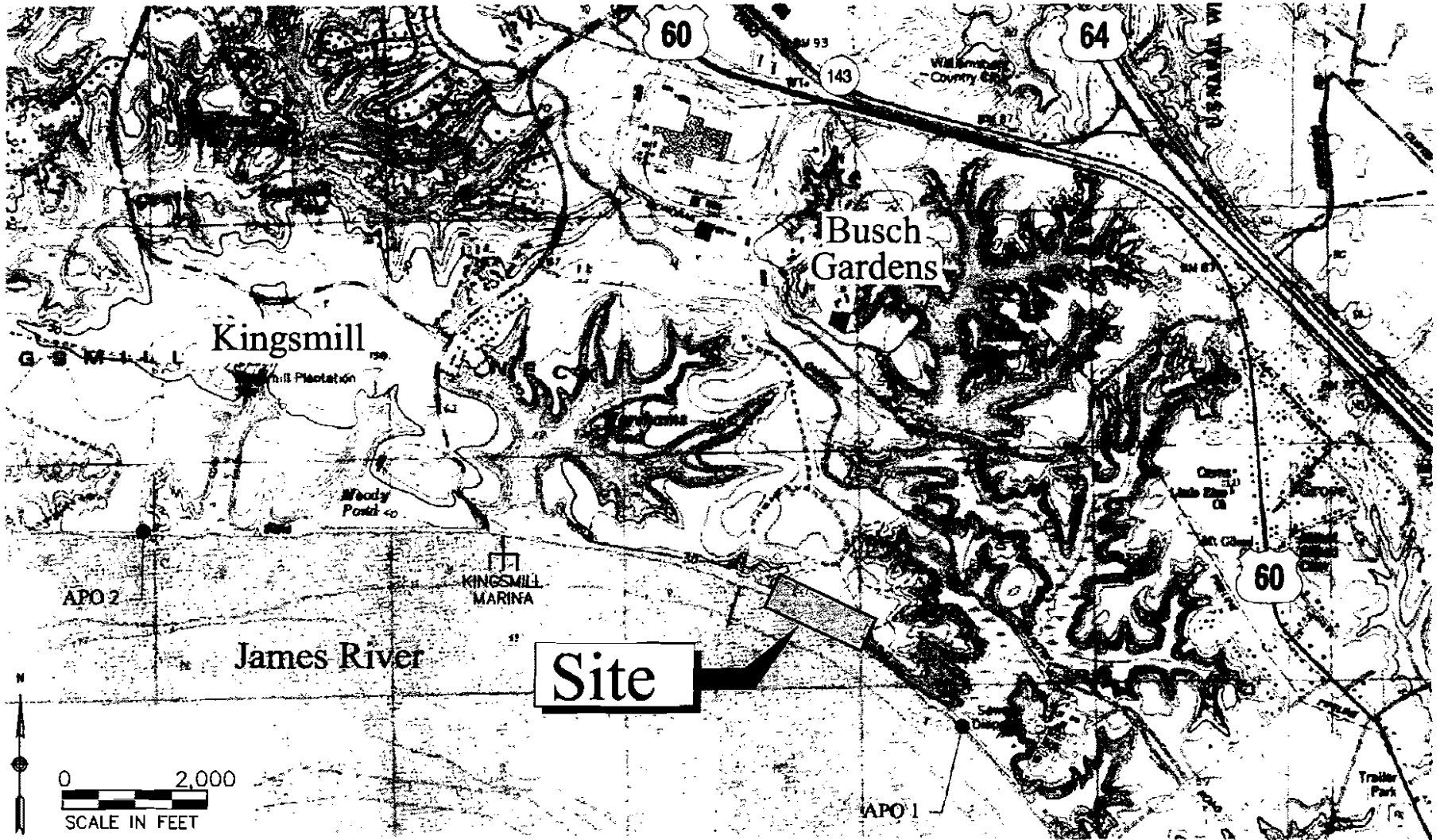

<p>VHB Vancee Hargen Brustlin, Inc. (757) 220-0500 • Fax: (757) 220-0544</p>	<p>ADJACENT PROPERTY OWNERS: 1. COLONIAL WILLIAMSBURG 2. DANIEL & ANNE CARR</p>	<p>KINGSMILL SPENCER'S GRANT SHORELINE STABILIZATION SITE LOCATION MAP</p>		<p>APPLICATION BY: COASTAL DESIGN & CONSTRUCTION</p>
<p>COASTAL Design & Construction, Inc.</p>	<p>DATUM: MEAN LOW WATER</p>	<p>AT: KINGSMILL RESORT IN: JAMES CITY COUNTY</p>	<p>PURPOSE: SHORELINE STABILIZATION PLAN</p>	<p>DATE: REVISED OCTOBER, 2007 SHEET 1 OF 13</p>

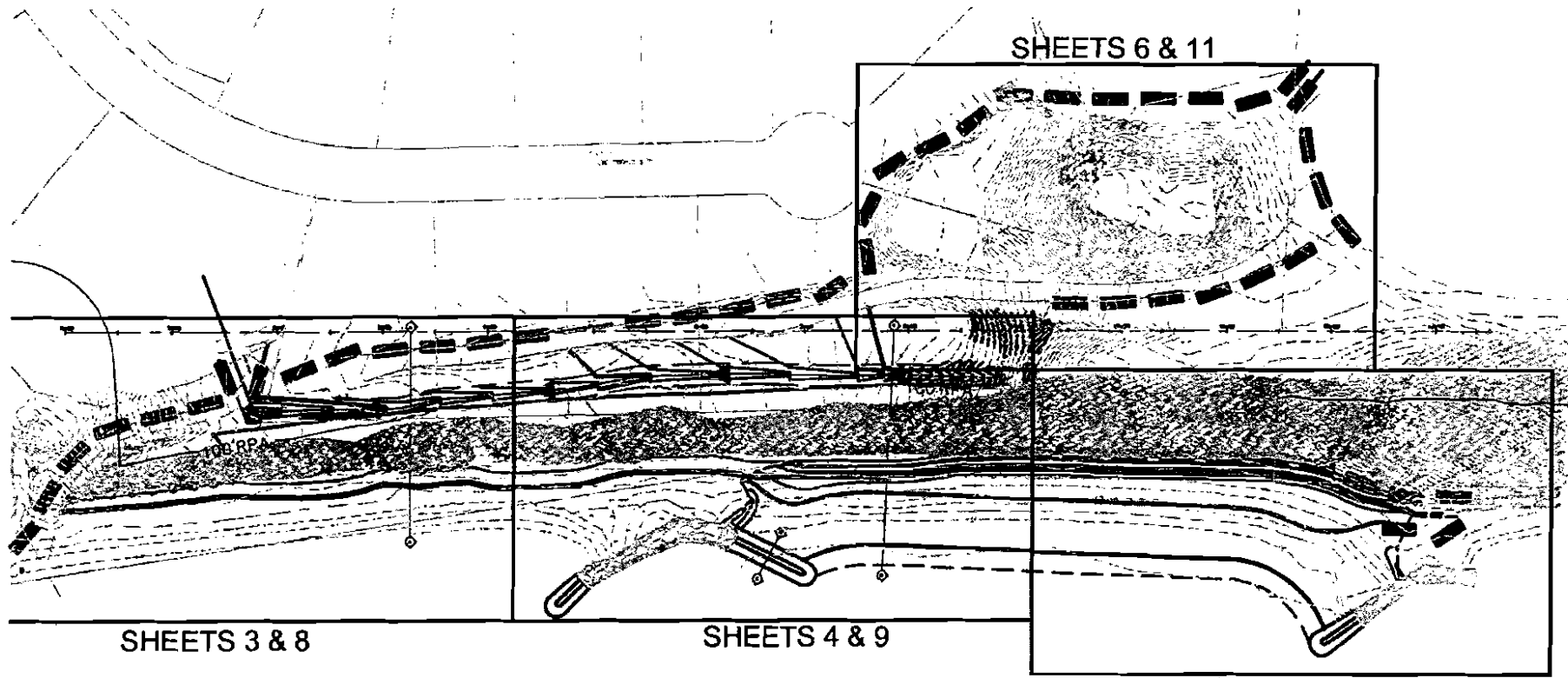

James River

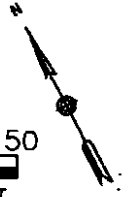

 Veness Hengen Brustlin, Inc. (767) 220-0800 • Fax (767) 220-8544	ADJACENT PROPERTY OWNERS: 1. COLONIAL WILLIAMSBURG 2. DANIEL & ANNE GARR	KINGSMILL SPENCER'S GRANT SHORELINE STABILIZATION INDEX SHEET		APPLICATION BY: COASTAL DESIGN & CONSTRUCTION
	DATUM: MEAN LOW WATER	AT: KINGSMILL REPORT IN: JAMES CITY COUNTY	PURPOSE: SHORELINE STABILIZATION PLAN	DATE: REVISED OCTOBER, 2007 SHEET 2 OF 13

\\hvo\proj\Williamsburg\32526.00\cad\ev\planset\JPA\32526-JPA-LM.dwg

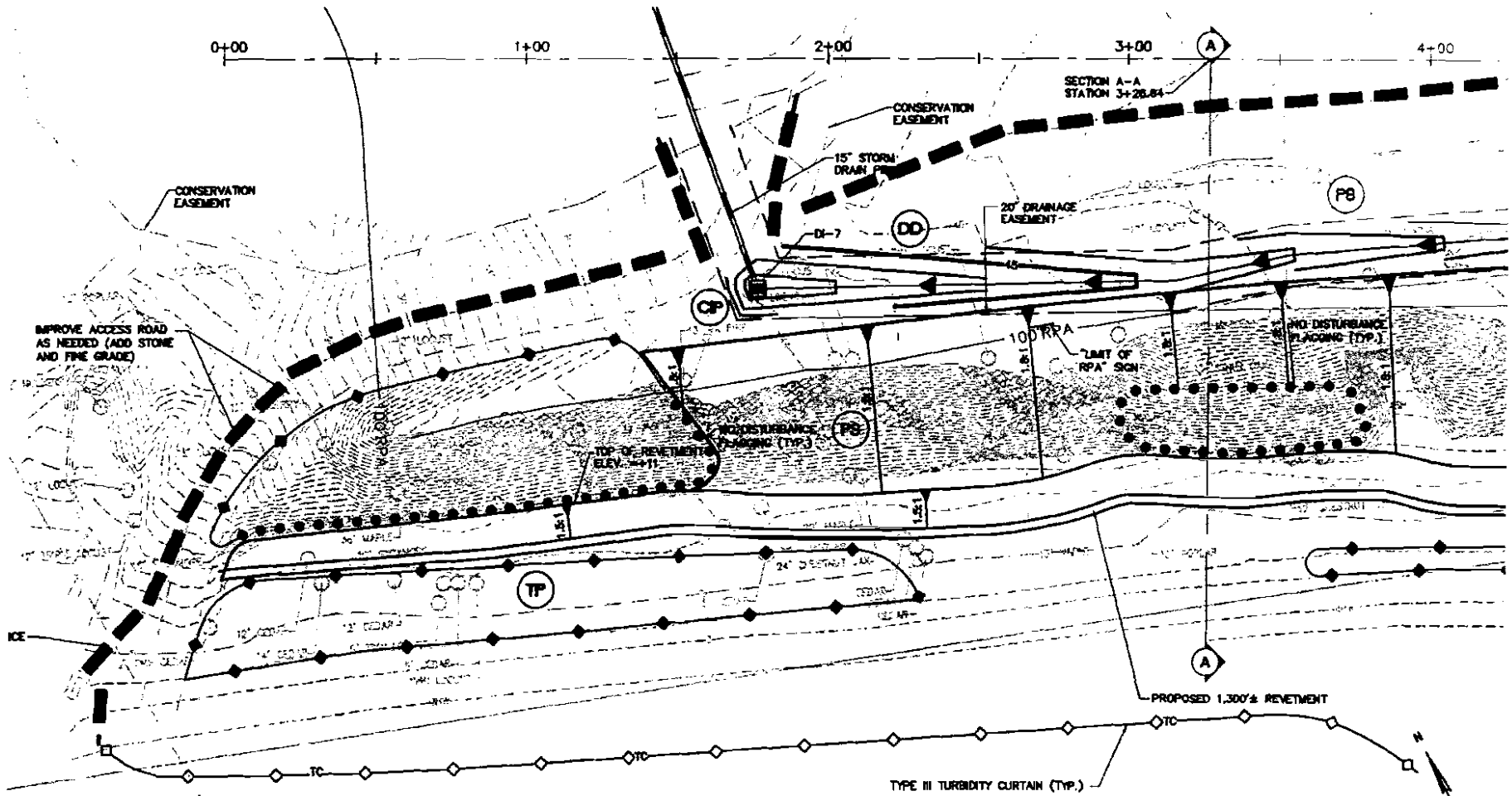

SEE SHEET 4

- ⊙ SF SILT FENCE
- ⊙ DD DIVERSION
- ⊙ TP TREE PRESERVATION & PROTECTION
- ⊙ PB PERMANENT SEEDING
- ⊙ B/M SOIL STABILIZATION BLANKET & MATTING
- ⊙ CE TEMPORARY STONE CONSTRUCTION ENTRANCE

VHB
Vanasse Hangen Brustlin, Inc.
(757) 220-0600 • Fax: (757) 220-0644

ADJACENT PROPERTY OWNERS:
1. COLONIAL WILLIAMSBURG
2. DANIEL & ANNE CARR

KINGSMILL SPENCER'S GRANT SHORELINE STABILIZATION
PROPOSED LAYOUT

APPLICATION BY:
COASTAL DESIGN & CONSTRUCTION



DATUM: MEAN LOW WATER

AT: KINGSMILL RESORT
IN: JAMES CITY COUNTY

PURPOSE: SHORELINE STABILIZATION PLAN

DATE: REVISED OCTOBER, 2007

SHEET 3 OF 13

\\hib\proj\williamsburg\32528.dwg\plan\set\lpa\32526--rpa--lm.dwg

SEE SHEET 6

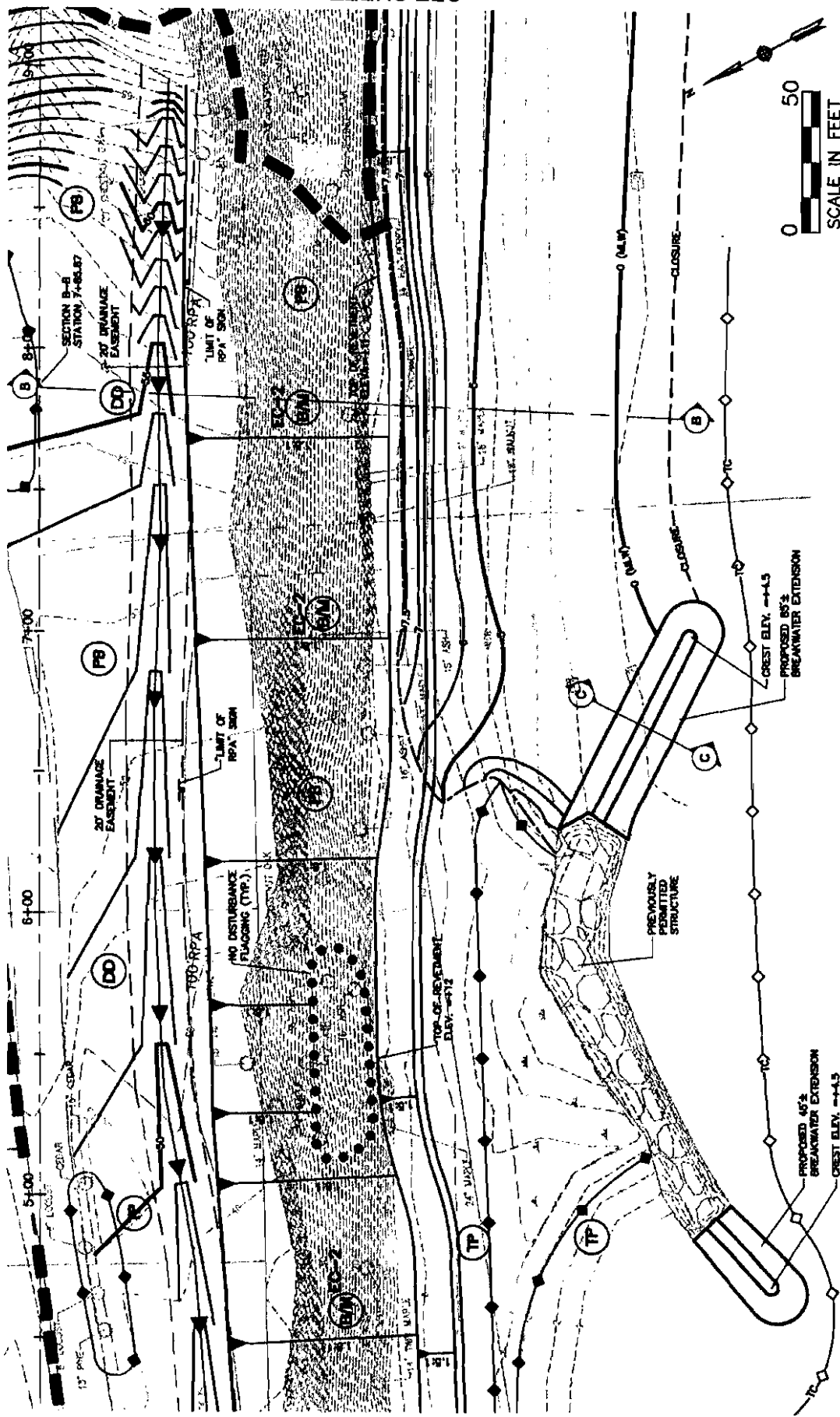

SEE SHEET 3

SEE SHEET 5

VHB
 Virginia Marine Contractors, Inc.
 (703) 299-0000 • Fax: (703) 299-0504

COASTAL
 DESIGN & CONSTRUCTION, INC.

ADJACENT PROPERTY OWNERS:
 1. COLONIAL WILLIAMSBURG
 2. DANIEL & ANNE CARR

DATUM: MEAN LOW WATER

KINGSMILL SPENCER'S GRANT SHORELINE STABILIZATION

PROPOSED LAYOUT

AT: KINGSMILL RESORT
IN: JAMES CITY COUNTY

APPLICATION BY:
 COASTAL DESIGN & CONSTRUCTION

REVERSED

DATE: OCTOBER, 2007

SHEET 4 OF 13

\\Hob\proj\Wilmington\32526.D0\road\env\plans\PA\32526-PA-LU.dwg

SEE SHEET 6

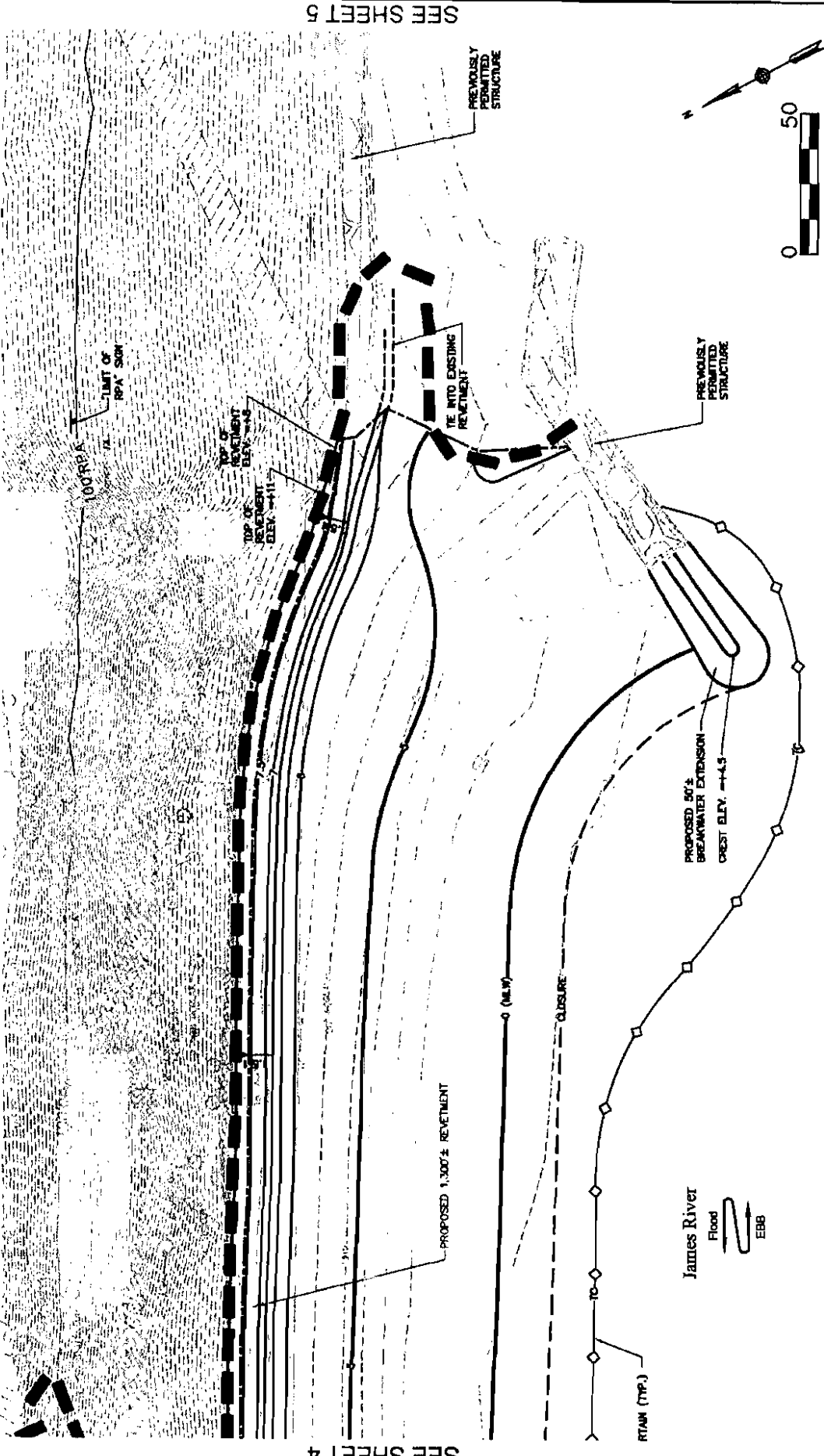

SEE SHEET 4

SEE SHEET 5

VHB
Virginia Henggen Bruellin, Inc.
(703) 290-0800 • Fax: (703) 220-8844

COASTAL
Design & Construction, Inc.

ADJACENT PROPERTY OWNERS:
1. COLONIAL WILLIAMSBURG
2. DANIEL & ANNE CARR

DATUM: MEAN LOW WATER

KINGSMILL SPENCER'S GRANT SHORELINE STABILIZATION
PROPOSED LAYOUT

AT: KINGSMILL RESORT
IN: JAMES CITY COUNTY

PURPOSE: SHORELINE STABILIZATION PLAN

APPLICATION BY:
COASTAL DESIGN & CONSTRUCTION

REVISED DATE: OCTOBER, 2007

SHEET 5 OF 13

\\hvo\proj\williamsburg\32526.dwg\cead\ev\planset\JPA\32526-JPA-LM.dwg

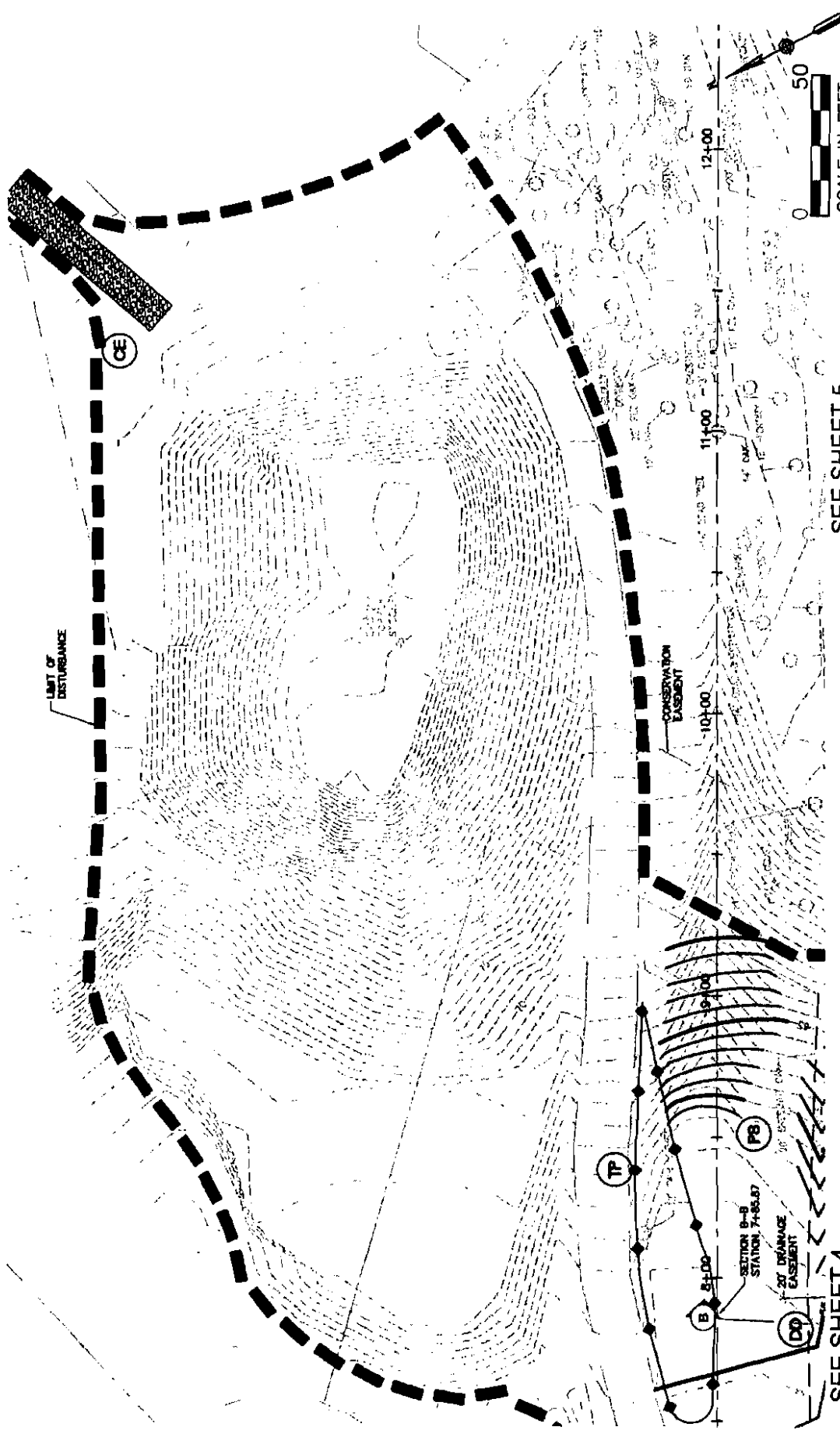

SEE SHEET 4

SEE SHEET 5

VHB Verrill Hansen Brantley, Inc. (707) 220-0900 • Fax: (707) 220-0844	ADJACENT PROPERTY OWNERS: 1. COLONIAL WILLIAMSBURG 2. DANIEL & ANNE CARR	KINGSMILL SPENCER'S GRANT SHORELINE STABILIZATION PROPOSED LAYOUT	APPLICATION BY: COASTAL DESIGN & CONSTRUCTION
	DATING: MEAN LOW WATER	AT: KINGSMILL RESORT IN: JAMES CITY COUNTY	PURPOSE: SHORELINE STABILIZATION PLAN
COASTAL DESIGN & CONSTRUCTION, INC.			SHEET 6 OF 13

Plant List

	Common Name	Botanical Name	Notes
Zone I (Upper beach)			
	Saltmeadow cordgrass American beachgrass Coastal panic grass Switch grass	Spartina patens Ammophila breviflora Panicum amarulum Panicum virgatum	(80%) 15 Centers (2" Peat Pot) (15%) 15 Centers (2" Peat Pot) (25%) 15 Centers (2" Peat Pot) (25%) 15 Centers (2" Peat Pot)
Zone II (Beach backshore)			
	Bald cypress	Taxodium distichum	Random Spacing (3 plants - 3gal.)
	Wax myrtle	Myrica cerifera	Random Spacing (20 plants - 3gal.)
	Groundsel tree	Baccharis halimifora	Random Spacing (50 plants - 3gal.)
	Eastern red cedar	Juniperus virginiana	Random Spacing (14 plants - 3gal.)
	Magnolia	Magnolia virginiana	Random Spacing (10 plants - 3gal.)
Zone IIIA (Lower Bank Slope) Area 17,097 sf.			
	Eastern red cedar Red bud Dogwood Virginia pine American beech American holly	Juniperus virginia Carals canadensis Cornus florida Pinus virginiana Fagus grandifolia Ilex opaca	Random Spacing (43 plants - 3gal.) Random Spacing (43 plants - 3gal.) Random Spacing (43 plants - 3gal.) Random Spacing (43 plants - 3gal.) Random Spacing (43 plants - 3gal.) Random Spacing (43 plants - 3gal.)
Zone III (Upper Bank Slope) Area 24,278			
	Wax myrtle Witch hazel American holly Dogwood Red bud	Myrica cerifera Hamamelis virginia Ilex opaca Cornus florida Carals canadensis	Random Spacing (73 plants - 3gal.) Random Spacing (73 plants - 3gal.) Random Spacing (73 plants - 3gal.) Random Spacing (73 plants - 3gal.) Random Spacing (73 plants - 3gal.)

VHB Vanessa Hangen Brustlin, Inc. (757) 220-0500 • Fax: (757) 220-8544	ADJACENT PROPERTY OWNERS: 1. COLONIAL WILLIAMSBURG 2. DANIEL & ANNE CARR	KINGSMILL SPENCER'S GRANT SHORELINE STABILIZATION PLANTING PLAN LEGEND AND DETAIL AT: KINGSMILL RESORT IN: JAMES CITY COUNTY	APPLICATION BY: COASTAL DESIGN & CONSTRUCTION DATE: REVISED OCTOBER, 2007 SHEET 7 OF 13
	DATUM: MEAN LOW WATER	PURPOSE: SHORELINE STABILIZATION PLAN	

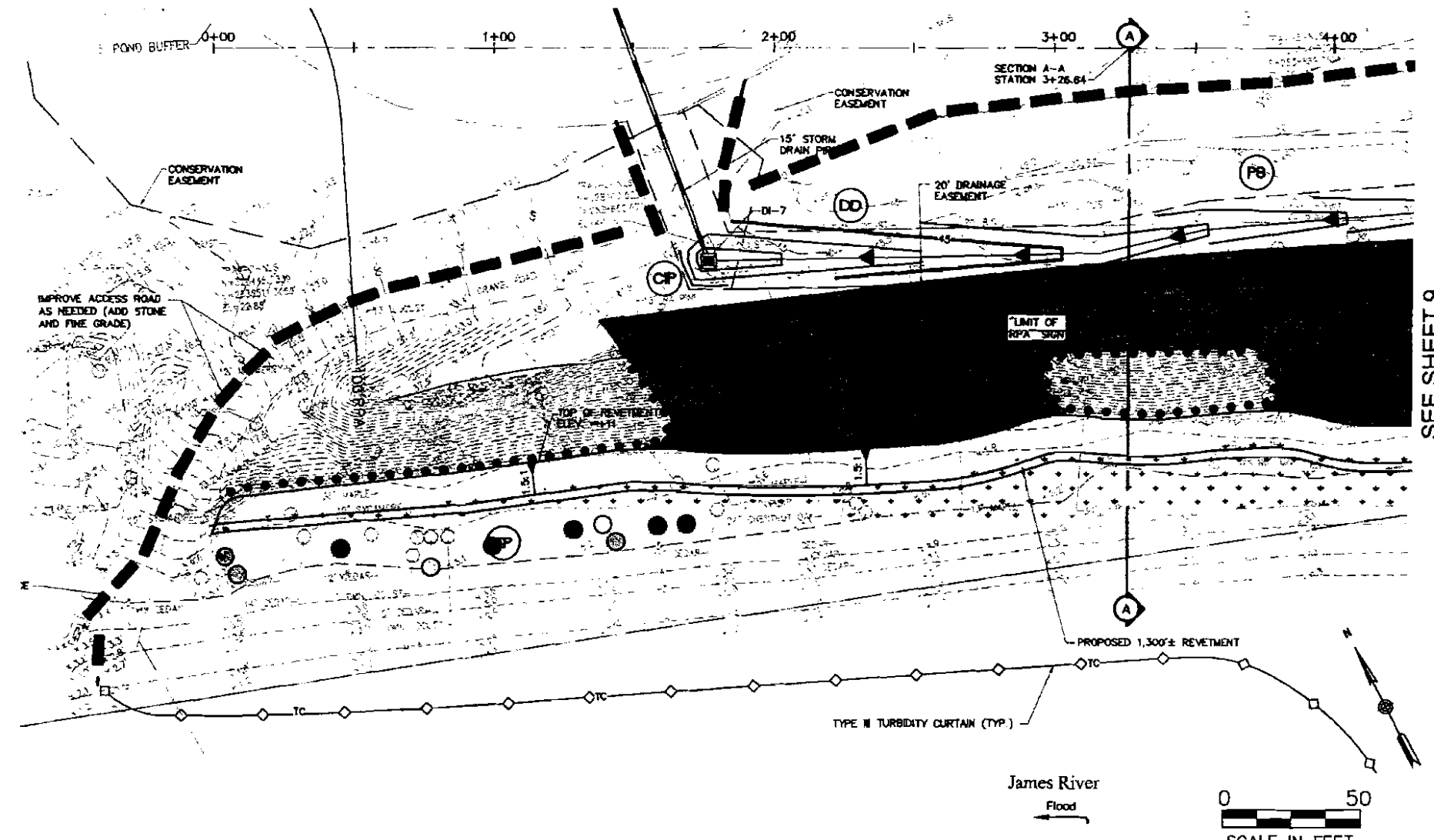

SEE SHEET 9



	ADJACENT PROPERTY OWNERS: 1. COLONIAL WILLIAMSBURG 2. DANIEL & ANNE CARR	KINGSMILL SPENCER'S GRANT SHORELINE STABILIZATION PROPOSED PLANTING PLAN		APPLICATION BY: COASTAL DESIGN & CONSTRUCTION
	DATUM: MEAN LOW WATER	AT: KINGSMILL RESORT IN: JAMES CITY COUNTY	PURPOSE: SHORELINE STABILIZATION PLAN	DATE: REVISED OCTOBER, 2007 SHEET 8 OF 13



\\vhb\pro\Williamsburg\32526 00\pdd\ev\plan\set\JPA\32526-JPA-PLAN\ING.dwg

SEE SHEET 11

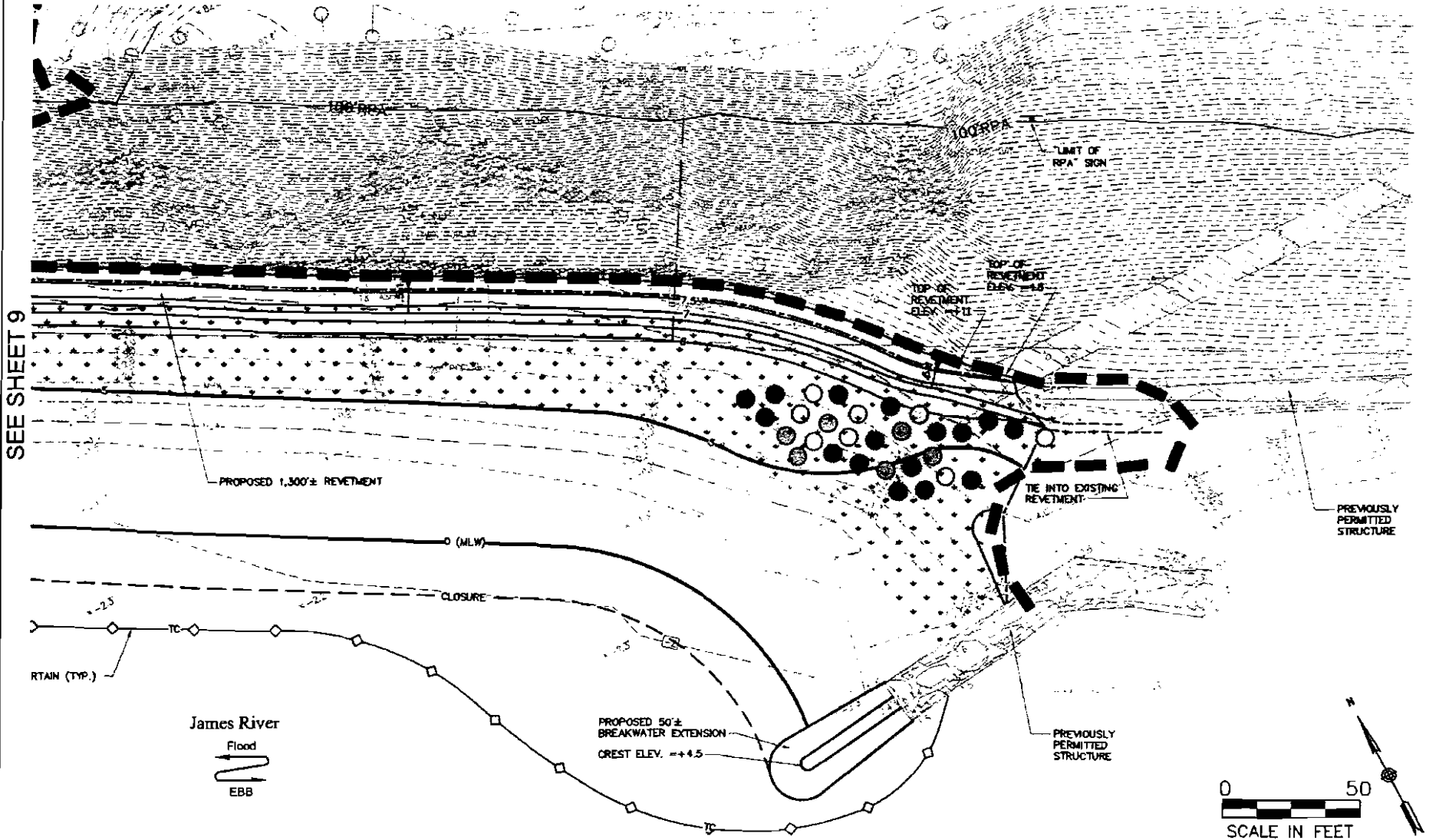

SEE SHEET 9

 Venesse Hengen Brustlin, Inc. (757) 220-0500 • Fax: (757) 220-9544	ADJACENT PROPERTY OWNERS: 1. COLONIAL WILLIAMSBURG 2. DANIEL & ANNE CARR	KINGSMILL SPENCER'S GRANT SHORELINE STABILIZATION PROPOSED PLANTING PLAN		APPLICATION BY: COASTAL DESIGN & CONSTRUCTION
	DATUM: MEAN LOW WATER	AT: KINGSMILL RESORT IN: JAMES CITY COUNTY	PURPOSE: SHORELINE STABILIZATION PLAN	DATE: REVISED OCTOBER, 2007
			SHEET 10 OF 13	



\\VHBS\proj\071001\071001.dwg Plot Date: 10/09/07

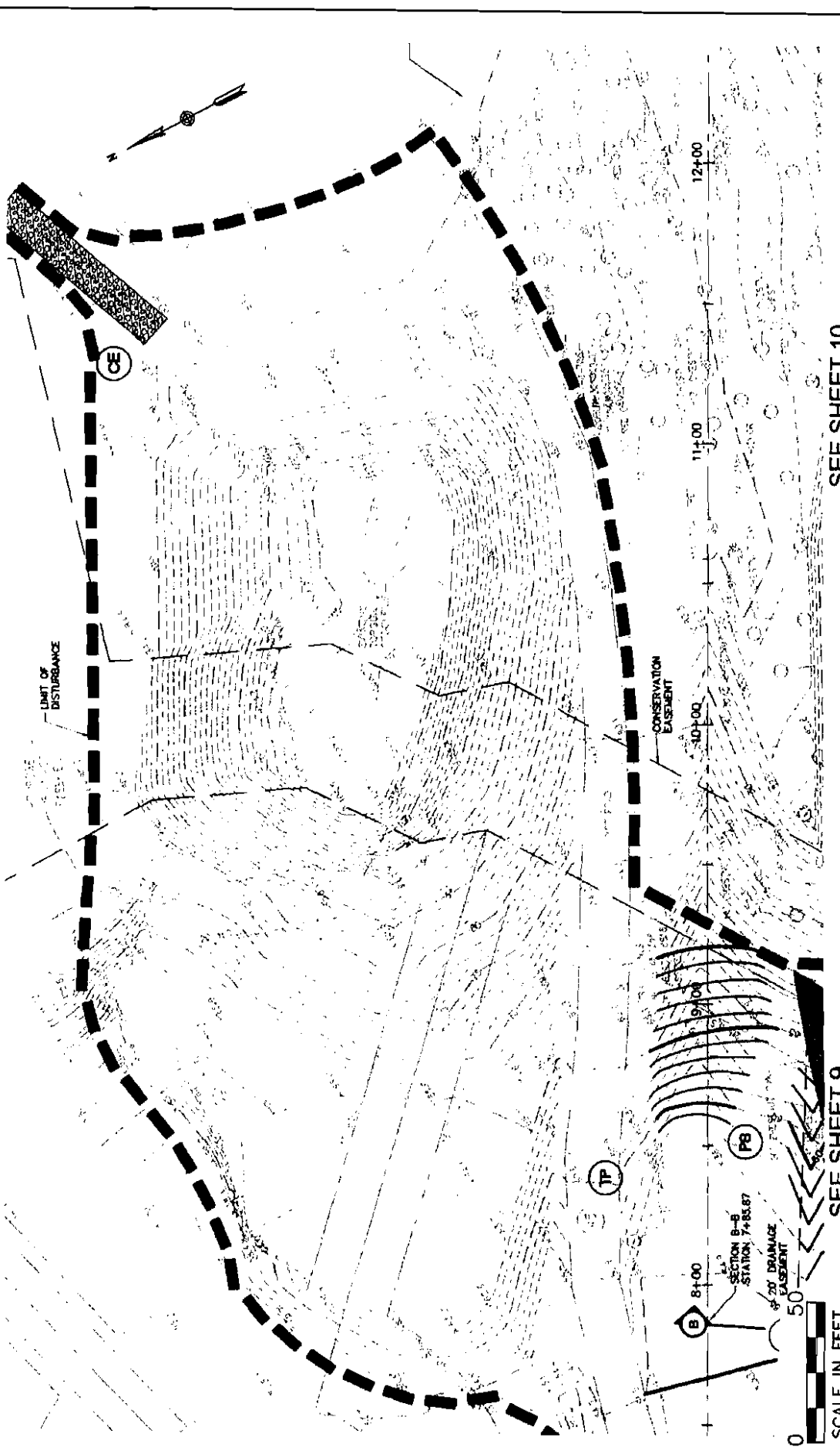

SEE SHEET 9

SEE SHEET 10

<p>VHB Vannese Hargren Brantley, Inc. (757) 220-0500 • Fax: (757) 220-6544</p>	<p>ADJACENT PROPERTY OWNERS: 1. COLONIAL WILLIAMSBURG 2. DANIEL & ANNE CARR</p>	<p>APPLICATION BY: COASTAL DESIGN & CONSTRUCTION</p>
<p>DATE: OCTOBER, 2007 SHEET 11 OF 13</p>	<p>PURPOSE: SHORELINE STABILIZATION PLAN</p>	<p>KINGSMILL SPENCER'S GRANT SHORELINE STABILIZATION PROPOSED PLANTING PLAN</p>
<p>DATUM: MEAN LOW WATER</p>	<p>AT: KINGSMILL RESORT IN: JAMES CITY COUNTY</p>	<p>COASTAL Design & Construction, Inc.</p>

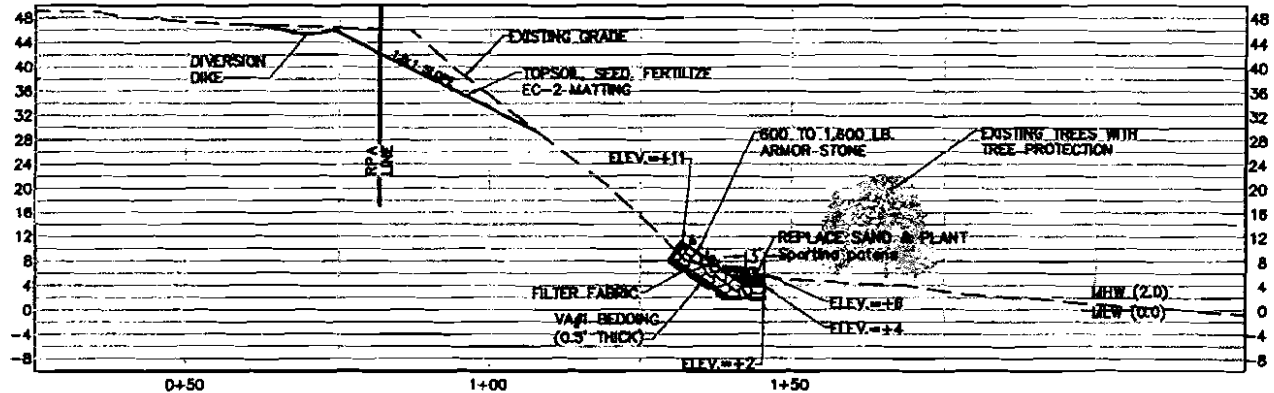

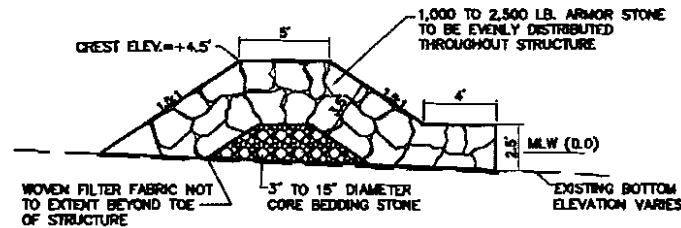

**Section A-A (0+00 to 3+50) & (4+75 to 6+75) & (10+00 to END)
For Indicated Toe Depth**



**Section C-C
Typical Breakwater Extension**



 Vanessa Hangan Brunelle, Inc. (767) 220-0000 • Fax (767) 220-8544	ADJACENT PROPERTY OWNERS: 1. COLONIAL WILLIAMSBURG 2. DANIEL & ANNE CARR	KINGSMILL SPENCER'S GRANT SHORELINE STABILIZATION		APPLICATION BY: COASTAL DESIGN & CONSTRUCTION
	DATUM: MEAN LOW WATER	AT: KINGSMILL RESORT IN: JAMES CITY COUNTY	CROSS SECTION	
				DATE: REVISED OCTOBER, 2007 SHEET 12 OF 13

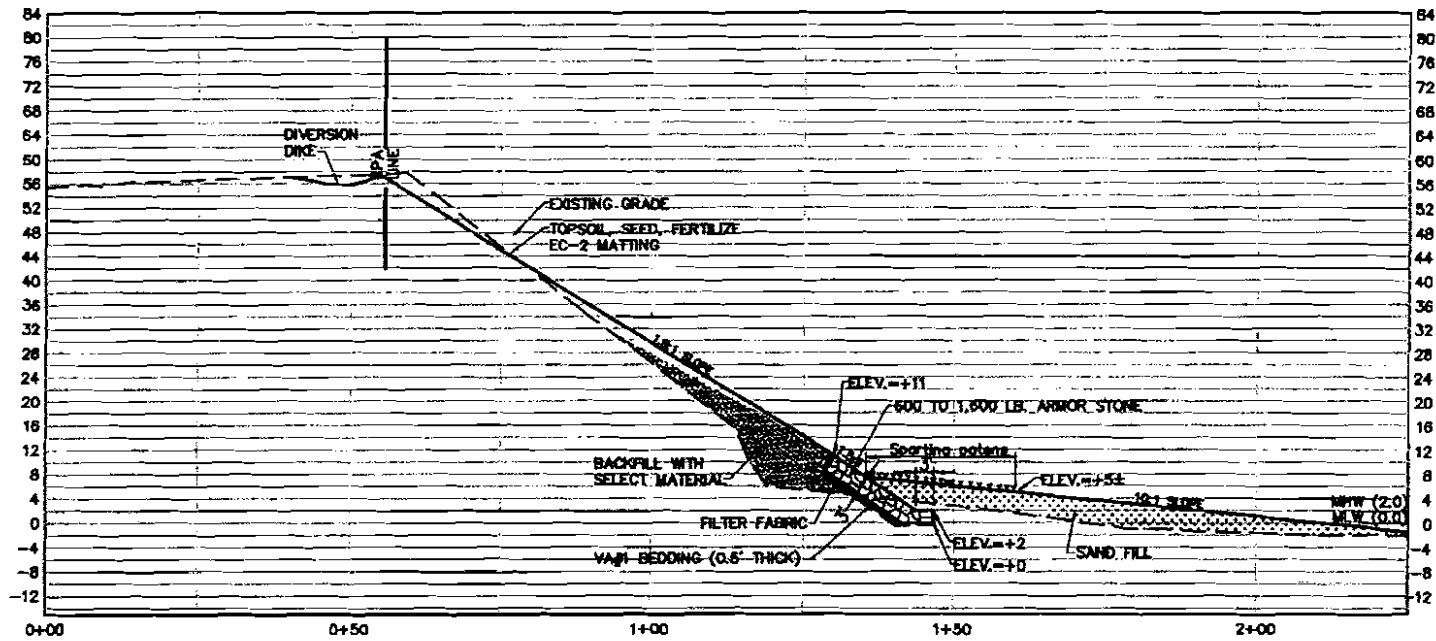

**Section B-B (3+50 to 4+75) & (6+75 to 10+00)
For Indicated Toe Depth**



 Verrane Hangen Bristol, Inc. (757) 220-0800 • Fax: (757) 220-8544	ADJACENT PROPERTY OWNERS: 1. COLONIAL WILLIAMSBURG 2. DANIEL & ANNE CARR	KINGSMILL SPENCER'S GRANT SHORELINE STABILIZATION CROSS SECTION		APPLICATION BY: COASTAL DESIGN & CONSTRUCTION
	DATUM: MEAN LOW WATER	AT: KINGSMILL REBORT IN: JAMES CITY COUNTY	PURPOSE: SHORELINE STABILIZATION PLAN	DATE: REVISED OCTOBER, 2007 SHEET 13 OF 19

VIMS Shoreline Permit Application Report # 07-1662

NOTE

The Virginia Institute of Marine Science (VIMS) recognizes that the regulatory process considers all aspects of a particular project, including socioeconomic factors. This report, however, only addresses marine environmental concerns.

Findings & Recommendations:

Existing Condition and Erosion Risk

The project shoreline along the James River has two existing breakwaters, with a sandy intertidal and supratidal area and a tall bluff. The sandy shore appears to afford adequate protection for much of the bank. Observations made of the bank upstream of the first breakwater identified few indicators of bank movement such as fallen trees, and soil slumping. The bank downstream showed some signs of movement. There is a notable natural vegetative community on the flat at the base of the bank, perched behind the sandy berm. This community is intercepting groundwater from the base of the bank and providing riparian bird and mammal habitat.

Impacts of Proposed Action

The proposed revetment will sever the connection between riparian, intertidal and subaqueous areas and convert native soils and vegetated areas to non-native rock. The result is a loss in the provision of water quality improvement processes and a change in the benthic community and associated forage animals.

The bank grading will impact about one acre and result in the loss of existing native vegetation and temporary soil disturbance and likely inputs into the waterway.

The proposed breakwater will cause the conversion nearshore shallow waters to rock and sandy shoreline. This will cause a shift in the benthic community and associated forage by crustaceans and shorebirds. The construction of the breakwater will cause temporary water quality impacts and may interrupt sediment transport. Breakwaters are effective in certain shoreline settings and when designed for a shoreline reach.

Recommendations

The preferred approach to shoreline protection for sandy shorelines is to enhance the natural capacity of the sand to provide the desired erosion protection. The critical element of this approach is beach nourishment in combination with a rock structure. The rock structure can be a nearshore sill, or offshore breakwater(s).

The bank grading should be limited to that area necessary to provide a stable slope and should account for the additional protection to be provided by the breakwater extensions and nourishment and plantings. Every effort should be made to avoid impacts to the vegetation on the flat particularly upstream of the first breakwater.

With the combined protection of the increased breakwater length, the beach nourishment and selected bank grading, we question the need for the entire 1300 feet of revetment, particularly in the lee of the enhanced breakwaters.

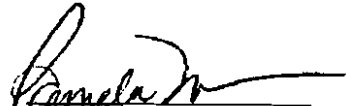

Pamela A. Mason
Marine Scientist

Melanie Davis

From: Melanie Davis
Sent: Friday, November 30, 2007 9:54 AM
To: 'ghjmaj@widowmaker.com'
Subject: FW: JCC Wetlands and ChesBay special meeting - Tues 12/11- 1:00pm

Public Notice

The James City County Chesapeake Bay and Wetlands Boards have scheduled a meeting for Tuesday, December 11, 2007 at 1:00 PM in the conference room of Building E, located at 101-E Mounts Bay Road, Williamsburg, Virginia, to review additional information regarding Wetlands case W-25-07 and Chesapeake Bay Exception CBE-07-107 for the Kingsmill - Spencer's Grant proposed shoreline project. For questions or more information, contact the Environmental Division at 757-253-6670.

Melanie Davis
Senior Engineering Assistant
James City County Environmental Division
email: mdavis@james-city.va.us
phone: 757-253-6866
fax: 757-259-4032